

MTEC

 γ : Spanwinkel γ : Angle de coupe γ : Rake angle

Rechts

A droite

Right hand

Links

A gauche

Left hand

Werkzeugtyp		Référence					Type of tool			MTEC...-R-K10	MTEC...-R-TiAlN	MTEC...-L-K10	MTEC...-L-TiAlN
$\varnothing S$	L	L ₁	L ₂	F	γ	$\varnothing D_{min}$	R	Ident. N°					
4	26	3	10	0,50	6°	1,0	0	...410030...	●	●	○	○	
							0,02×45°	...41003...	●	●	○	○	
4	26	5	10	0,50	6°	1,0	0	...410050...	●	●	●	●	
							0,02×45°	...41005...	●	●	●	●	
4	31	4	15	0,60	12°	1,2	0	...412040...	●	●	○	○	
							0,02×45°	...41204...	●	●	○	○	
4	31	7	15	0,60	12°	1,2	0	...412070...	●	●	○	○	
							0,02×45°	...41207...	●	●	○	○	
4	31	5	15	0,75	12°	1,5	0	...415050...	●	●	○	○	
							0,02×45°	...41505...	●	●	○	○	
4	31	8	15	0,75	12°	1,5	0	...415080...	●	●	●	●	
							0,02×45°	...41508...	●	●	●	●	
4	31	5	15	0,90	12°	1,8	0	...418050...	●	●	○	○	
							0,03×45°	...41805...	●	●	●	●	
4	31	9	15	0,90	12°	1,8	0	...418090...	●	●	●	●	
							0,03×45°	...41809...	●	●	●	●	
4	31	14	15	0,90	12°	1,8	0	...418140...	●	●	○	○	
							0,03×45°	...41814...	●	●	○	○	
4	31	6	15	1,10	12°	2,2	0	...422060...	●	●	○	○	
							R0,05	...42206...	●	●	○	○	
4	31	10	15	1,10	12°	2,2	0	...422100...	●	●	○	○	
							R0,05	...42210...	●	●	○	○	
4	31	14	15	1,10	12°	2,2	0	...422140...	●	●	○	○	
							R0,05	...42214...	●	●	○	○	
4	31	6	15	1,25	12°	2,5	0	...425060...	●	●	●	●	
							R0,05	...42506...	●	●	●	●	
4	31	10	15	1,25	12°	2,5	0	...425100...	●	●	○	○	
							R0,05	...42510...	●	●	○	○	
4	31	14	15	1,25	12°	2,5	0	...425140...	●	●	○	○	
							R0,05	...42514...	●	●	○	○	
4	31	8	15	1,60	12°	3,2	0	...432080...	●	●	○	○	
							R0,05	...432085...	●	●	○	○	
							R0,08	...43208...	●	●	○	○	
4	31	12	15	1,60	12°	3,2	0	...432120...	●	●	○	○	
							R0,05	...432125...	●	●	○	○	
							R0,08	...43212...	●	●	●	●	
4	36	17	20	1,60	12°	3,2	0	...432170...	●	●	○	○	
							R0,05	...432175...	●	●	○	○	
							R0,08	...43217...	●	●	○	○	
4	31	10	15	1,95	12°	4,0	0	...440100...	●	●	●	●	
							R0,05	...440105...	●	●	●	●	
							R0,12	...44010...	●	●	●	●	
4	31	14	15	1,95	12°	4,0	0	...440140...	●	●	○	○	
							R0,05	...440145...	●	●	○	○	
							R0,12	...44014...	●	●	○	○	
4	36	19	20	1,95	12°	4,0	0	...440190...	●	●	○	○	
							R0,05	...440195...	●	●	○	○	
							R0,12	...44019...	●	●	●	●	

Bestell-Nr.: entsprechenden Werkzeugtyp und Ident.-Nr. zusammenfügen, z.B.: MTEC-410030-R-K10

- Lieferbar ab Lager
- Lieferfrist auf Anfrage

N° de commande: joindre le numéro d'identification à la référence, par exemple: MTEC-410030-R-K10

- Livrable du stock
- Délai de livraison sur demande

Order number: Add Ident. No. to type of tool, e.g.: MTEC-410030-R-K10

- Available ex stock
- Delivery time on request

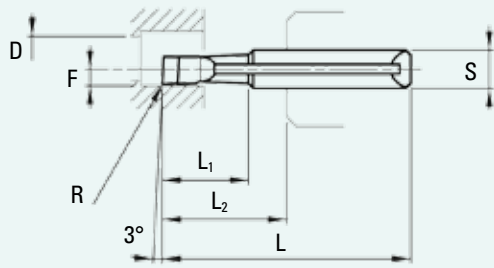

MTEC



γ: Spanwinkel		γ: Angle de coupe		γ: Rake angle		Rechts	A droite	Right hand	Links	A gauche	Left hand
Werkzeugtyp		Référence		Type of tool		MTEC...-R-K10	MTEC...-R-TiAIN	MTEC...-L-K10	MTEC...-L-TiAIN		
ØS	L	L ₁	L ₂	F	γ	ØD _{min}	R	Ident. N°			
6	48	25	29	1,95	12°	4,0	0	...640250...	•	•	○
							R0,05	...640255...	•	•	○
							R0,12	...64025...	•	•	○
6	53	30	34	1,95	12°	4,0	0	...640300...	•	•	○
							R0,05	...640305...	•	•	○
							R0,12	...64030...	•	•	○
6	35	12	16	2,50	12°	5,0	R0,05	...650125...	•	•	•
							R0,15	...65012...	•	•	•
6	43	17	24	2,50	12°	5,0	R0,05	...650175...	•	•	•
							R0,15	...65017...	•	•	•
6	48	25	29	2,50	12°	5,0	R0,05	...650255...	•	•	•
							R0,15	...65025...	•	•	•
6	53	32	34	2,50	12°	5,0	R0,05	...650325...	•	•	○
							R0,15	...65032...	•	•	○
6	61	40	42	2,50	12°	5,0	R0,05	...650405...	•	•	○
							R0,15	...65040...	•	•	•
6	35	12	16	2,95	12°	6,0	R0,05	...660125...	•	•	•
							R0,20	...66012...	•	•	•
6	43	20	24	2,95	12°	6,0	R0,05	...660205...	•	•	•
							R0,20	...66020...	•	•	•
6	53	30	34	2,95	12°	6,0	R0,05	...660305...	•	•	•
							R0,20	...66030...	•	•	•
6	61	40	42	2,95	12°	6,0	R0,05	...660405...	•	•	○
							R0,20	...66040...	•	•	○
6	71	50	52	2,95	12°	6,0	R0,05	...660505...	•	•	○
							R0,20	...66050	•	•	○

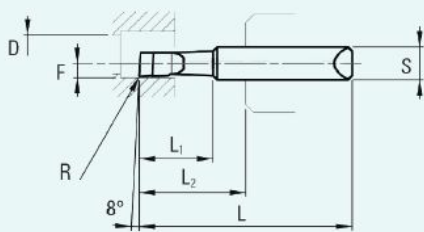

MTEE



Spanwinkel 8°		Angle de coupe 8°		Rake angle 8°		Rechts	A droite	Right hand
Werkzeugtyp		Référence		Type of tool		MTEE...-R-K10	MTEE...-R-TiAIN	
ØS	L	L ₁	L ₂	F	ØD _{min}	R	Ident. N°	
4	31	5,0	15	0,95	1,8	R0,05	MTEE 41805-R	•
4	31	7,0	15	1,20	2,3	R0,08	MTEE 42307-R	•
4	31	8,5	15	1,45	2,8	R0,10	MTEE 42808-R	•
4	31	10,5	15	1,70	3,3	R0,10	MTEE 43310-R	•
4	31	12,5	15	1,95	3,8	R0,10	MTEE 43812-R	•
6	43	16,0	24	2,45	4,7	R0,15	MTEE 64716-R	•
6	43	19,5	24	2,95	5,7	R0,15	MTEE 65719-R	•

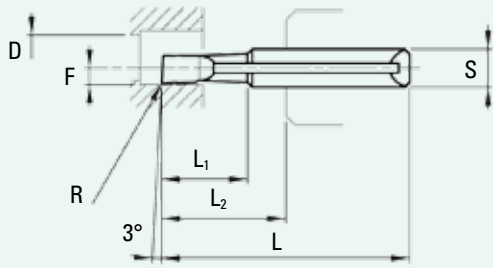

MTEN



γ: Spanwinkel

γ: Angle de coupe

γ: Rake angle

Rechts

A droite

Right hand

Links

A gauche

Left hand

Werkzeugtyp		Référence					Type of tool						
∅S	L	L ₁	L ₂	F	γ	∅D _{min}	R	Ident. N°	MTEN...-R-K10	MTEN...-R-TiAlN	MTEN...-L-K10	MTEN...-L-TiAlN	
4	26	0,4	10	0,15	0°	0,3	0	...403010...	•	•	○	○	
4	26	0,5	10	0,20	0°	0,4	0	...404010...	•	•	○	○	
4	26	0,6	10	0,25	0°	0,5	0	...405010...	•	•	○	○	
4	26	1,5	10	0,25	0°	0,5	0	...405020...	•	•	•	•	
4	26	0,8	10	0,35	0°	0,7	0	...407010...	•	•	○	○	
4	26	2	10	0,35	0°	0,7	0	...407020...	•	•	•	•	
							0,02×45°	...40702...	•	•	•	•	
4	26	1,2	10	0,50	0°	1,0	0	...410020...	•	•	○	○	
4	26	3	10	0,50	0°	1,0	0	...410030...	•	•	•	•	
							0,02×45°	...41003...	•	•	○	○	
4	26	5	10	0,50	0°	1,0	0	...410050...	•	•	•	•	
							0,02×45°	...41005...	•	•	•	•	
4	26	2	10	0,60	0°	1,2	0	...412020...	•	•	○	○	
4	31	4	15	0,60	0°	1,2	0	...412040...	•	•	•	•	
							0,02×45°	...41204...	•	•	○	○	
4	31	7	15	0,60	0°	1,2	0	...412070...	•	•	•	•	
							0,02×45°	...41207...	•	•	•	•	
4	26	3	10	0,75	0°	1,5	0	...415030...	•	•	○	○	
4	31	5	15	0,75	0°	1,5	0	...415050...	•	•	•	•	
							0,02×45°	...41505...	•	•	•	•	
4	31	8	15	0,75	0°	1,5	0	...415080...	•	•	•	•	
							0,02×45°	...41508...	•	•	•	•	
4	26	4	10	0,90	0°	1,8	0	...418040...	•	•	○	○	
4	31	5	15	0,90	0°	1,8	0	...418050...	•	•	•	•	
							0,03×45°	...41805...	•	•	•	•	
4	31	9	15	0,90	0°	1,8	0	...418090...	•	•	•	•	
							0,03×45°	...41809...	•	•	•	•	
4	31	14	15	0,90	0°	1,8	0	...418140...	•	•	○	○	
							0,03×45°	...41814...	•	•	○	○	
4	31	6	15	1,10	0°	2,2	0	...422060...	•	•	○	○	
							R0,05	...42206...	•	•	○	○	
4	31	10	15	1,10	0°	2,2	0	...422100...	•	•	○	○	
							R0,05	...42210...	•	•	○	○	
4	31	14	15	1,10	0°	2,2	0	...422140...	•	•	○	○	
							R0,05	...42214...	•	•	○	○	
4	31	6	15	1,25	0°	2,5	0	...425060...	•	•	•	•	
							R0,05	...42506...	•	•	•	•	
4	31	10	15	1,25	0°	2,5	0	...425100...	•	•	•	•	
							R0,05	...42510...	•	•	•	•	
4	31	14	15	1,25	0°	2,5	0	...425140...	•	•	○	○	
							R0,05	...42514...	•	•	○	○	

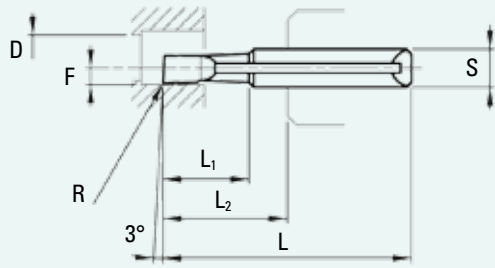

MTEN



Werkzeugtyp		Référence					Type of tool			Rechts	A droite	Right hand	Links	A gauche	Left hand
ØS	L	L ₁	L ₂	F	γ	ØD _{min}	R	Ident. N°	MTEN...-R-K10	MTEN...-R-TiAIN	MTEN...-L-K10	MTEN...-L-TiAIN			
4	31	8	15	1,60	0°	3,2	0	...432080...	●	●	●	●			
							R0,05	...432085...	●	●	●	●			
							R0,08	...43208...	●	●	●	●			
4	31	12	15	1,60	0°	3,2	0	...432120...	●	●	●	●			
							R0,05	...432125...	●	●	●	●			
							R0,08	...43212...	●	●	●	●			
4	36	17	20	1,60	0°	3,2	0	...432170...	●	●	○	○			
							R0,05	...432175...	●	●	○	○			
							R0,08	...43217...	●	●	○	○			
4	31	10	15	1,95	0°	4,0	0	...440100...	●	●	●	●			
							R0,05	...440105...	●	●	●	●			
							R0,12	...44010...	●	●	●	●			
4	31	14	15	1,95	0°	4,0	0	...440140...	●	●	●	●			
							R0,05	...440145...	●	●	●	●			
							R0,12	...44014...	●	●	●	●			
4	36	19	20	1,95	0°	4,0	0	...440190...	●	●	●	●			
							R0,05	...440195...	●	●	●	●			
							R0,12	...44019...	●	●	●	●			
6	48	25	29	1,95	0°	4,0	0	...640250...	●	●	○	○			
							R0,05	...640255...	●	●	○	○			
							R0,12	...64025...	●	●	○	○			
6	53	30	34	1,95	0°	4,0	0	...640300...	●	●	○	○			
							R0,05	...640305...	●	●	○	○			
							R0,12	...64030...	●	●	○	○			
6	35	12	16	2,50	0°	5,0	R0,05	...650125...	●	●	●	●			
							R0,15	...65012...	●	●	●	●			
6	43	17	24	2,50	0°	5,0	R0,05	...650175...	●	●	●	●			
							R0,15	...65017...	●	●	●	●			
6	48	25	29	2,50	0°	5,0	R0,05	...650255...	●	●	●	●			
							R0,15	...65025...	●	●	●	●			
6	53	32	34	2,50	0°	5,0	R0,05	...650325...	●	●	○	○			
							R0,15	...65032...	●	●	○	○			
6	61	40	42	2,50	0°	5,0	R0,05	...650405...	●	●	○	○			
							R0,15	...65040...	●	●	○	○			
6	35	12	16	2,95	0°	6,0	R0,05	...660125...	●	●	●	●			
							R0,20	...66012...	●	●	●	●			
6	43	20	24	2,95	0°	6,0	R0,05	...660205...	●	●	●	●			
							R0,20	...66020...	●	●	●	●			
6	53	30	34	2,95	0°	6,0	R0,05	...660305...	●	●	●	●			
							R0,20	...66030...	●	●	●	●			
6	61	40	42	2,95	0°	6,0	R0,05	...660405...	●	●	○	○			
							R0,20	...66040...	●	●	○	○			
6	71	50	52	2,95	0°	6,0	R0,05	...660505...	●	●	○	○			
							R0,20	...66050	●	●	○	○			

Bestell-Nr.: entsprechenden Werkzeugtyp und Ident.-Nr. zusammenfügen, z.B.: MTEN-432080-R-K10

- Lieferbar ab Lager
- Lieferfrist auf Anfrage

N° de commande: joindre le numéro d'identification à la référence, par exemple: MTEN-432080-R-K10

- Livrable du stock
- Délai de livraison sur demande

Order number: Add ident. No. to type of tool, e.g.: MTEN-432080-R-K10

- Available ex stock
- Delivery time on request

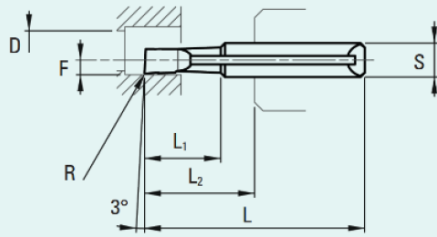

γ : Spanwinkel γ : Angle de coupe γ : Rake angle

Werkzeugtyp Référence Type of tool

$\varnothing S$	L	L ₁	L ₂	F	γ	$\varnothing D_{min}$	R, MTEF	R, MTEP	MTEF	MTEP
4	26	1.2	10	0.50	12°	1.0	0		MTEF-410020-R-K10	
4	26	3	10	0.50	12°	1.0	0		MTEF-410030-R-K10	
4	26	5	10	0.50	12°	1.0	0		MTEF-410050-R-K10	
4	26	2	10	0.60	12°	1.2	0		MTEF-412020-R-K10	
4	31	4	15	0.60	12°	1.2	0		MTEF-412040-R-K10	
4	31	7	15	0.60	12°	1.2	0		MTEF-412070-R-K10	
4	26	3	10	0.75	12°	1.5	0		MTEF-415030-R-K10	
4	31	5	15	0.75	12°	1.5	0		MTEF-415050-R-K10	
4	31	8	15	0.75	12°	1.5	0		MTEF-415080-R-K10	
4	26	4	10	0.90	12°	1.8	0		MTEF-418040-R-K10	
4	31	5	15	0.90	12°	1.8	0		MTEF-418050-R-K10	
4	31	9	15	0.90	12°	1.8	0		MTEF-418090-R-K10	
4	31	6	15	1.10	12°	2.2	0		MTEF-422060-R-K10	
4	31	10	15	1.10	12°	2.2	0		MTEF-422100-R-K10	
4	31	14	15	1.10	12°	2.2	0		MTEF-422140-R-K10	
4	31	6	15	1.25	12°	2.5	0.02x45°	R0.05	MTEF-425062-R-K10	MTEP-425065-R-K10
4	31	10	15	1.25	12°	2.5	0.02x45°	R0.05	MTEF-425102-R-K10	MTEP-425105-R-K10
4	31	14	15	1.25	12°	2.5	0.02x45°	R0.05	MTEF-425142-R-K10	MTEP-425145-R-K10
4	31	8	15	1.60	12°	3.2	0.02x45°	R0.05	MTEF-432082-R-K10	MTEP-432085-R-K10
4	31	12	15	1.60	12°	3.2	0.02x45°	R0.05	MTEF-432122-R-K10	MTEP-432125-R-K10
4	36	17	20	1.60	12°	3.2	0.02x45°	R0.05	MTEF-432172-R-K10	MTEP-432175-R-K10
4	31	10	15	1.95	12°	4.0	0.02x45°	R0.05	MTEF-440102-R-K10	MTEP-440105-R-K10
4	31	14	15	1.95	12°	4.0	0.02x45°	R0.05	MTEF-440142-R-K10	MTEP-440145-R-K10
4	36	19	20	1.95	12°	4.0	0.02x45°	R0.05	MTEF-440192-R-K10	MTEP-440195-R-K10
6	35	12	16	2.50	12°	5.0	0.02x45°	R0.05	MTEF-650122-R-K10	MTEP-650125-R-K10
6	43	17	24	2.50	12°	5.0	0.02x45°	R0.05	MTEF-650172-R-K10	MTEP-650175-R-K10
6	48	25	29	2.50	12°	5.0	0.02x45°	R0.05	MTEF-650252-R-K10	MTEP-650255-R-K10
6	35	12	16	2.95	12°	6.0	0.02x45°	R0.05	MTEF-660122-R-K10	MTEP-660125-R-K10
6	43	20	24	2.95	12°	6.0	0.02x45°	R0.05	MTEF-660202-R-K10	MTEP-660205-R-K10
6	53	30	34	2.95	12°	6.0	0.02x45°	R0.05	MTEF-660302-R-K10	MTEP-660305-R-K10

MTEF

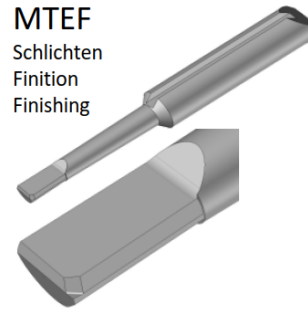
Schlichten
Finition
Finishing

MTEP

Schruppen
Ébauche
Roughing